



*Performing Arts Division –
Technical Support Unit*

East Kowloon Cultural Centre

60 Ngau Tau Kok Road,
Kowloon, HK

Phone
852-3166 2800

Fax
852-3547 2698

CONTACTS

Jimmy FONG

Senior Manager (EKCC) 1
Direct Line
852- 3166 2801
Email
jhwfong@lcsd.gov.hk

Joey CHO

Manager (EKCC) 2
Direct Line
852- 3166 2805
Email
jhmcho@lcsd.gov.hk

Andy TSUI

Resident Technical Manager (EKCC)
Direct Line
852- 3166 2825
Email
ayotsui@lcsd.gov.hk

GENERAL SET-UP

*The Beats operates on a
'bare-wall' touring policy.*

*That is, all equipment is nor-
mally set-up and struck within
the booking period.*

*Hirers are reminded to allow
sufficient preparation time to
hang theatre masking, rig all
overhead stage lighting and
set up sound system.*

*Check with our Resident
Technical Manager for any
other equipment and tech-
nical enquiries.*

East Kowloon Cultural Centre – The Beats FULL Technical Information

V. 2025.09.19

Page 1 of 7



EKCC The Beats is equipped with professional audio mixing and amplifying systems as well as soundproof walls, ideal for music band shows, amplified concerts and music recordings.

DIRECTIONS

MTR

Kwun Tong Line,
Kowloon Bay Station, Exit B

Bus:

Kowloon Bay Station (East Kowloon
Cultural Centre) Bus Stop,
Amoy Gardens Bus Stop

From HK Island W:

Cross Harbour Tunnel → East Kowloon
Corridor → Kai Tak Tunnel → Prince
Edward Road East → Kwun Tong Road
→ Fuk To Street

From HK Island E:

Eastern Harbour Tunnel → Kwun Tong
Bypass → Kai Fuk Road → Kai Cheung
Road → Ngau Tau Kok Road → Fuk To
Street

From New Territories

Lion Rock Tunnel / Tate's Cairn Tunnel
→ Lung Cheung Road → Kwun Tong
Road → Fuk To Street

Nearby Public Car Parks

Telford Plaza, Amoy Plaza,
Lower Ngau Tau Kok Estate



LOADING

Lift and Dock on G/F are shared use with The Lab and The Turns

Clearance for truck: 4.70m (H)
Truck Occupancy: 2nos. 5.5-Tone Lorry
Dock Height: 1.20m

Cargo Lift S2 from ground floor:

Door Dimension:
2.50 x 2.40m (W x H)
3.46 m (Diagonal)
Lift Dimension:
3.70 x 2.70m (W x H)
2.50m (Depth)

STAGE ENTRANCE

Ngau Tau Kok Road, facing Amoy Plaza

PARKING

Permit required



AUDITORIUM

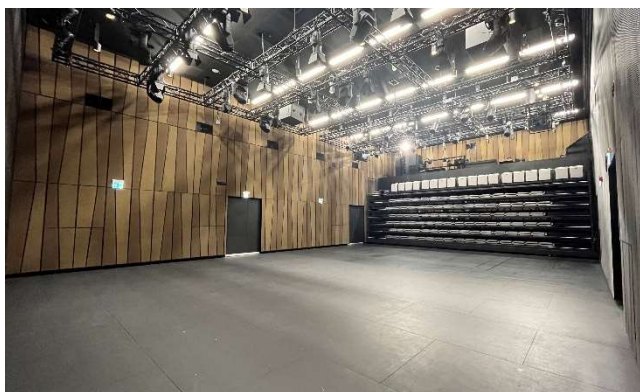

Total Seating 120
Wheelchair Space: 4

END STAGE (120 seats)

Width 11.00m from wall to wall
Depth 7.40m first row to back wall
Area 81.40m²

FLAT FLOOR (no seats)

Width 11.00m from wall to wall
Depth 14.50m seating retracted
Area 159.50 m²

REVERBERATION TIME

0.5s

(averages at 500Hz and 1kHz) :

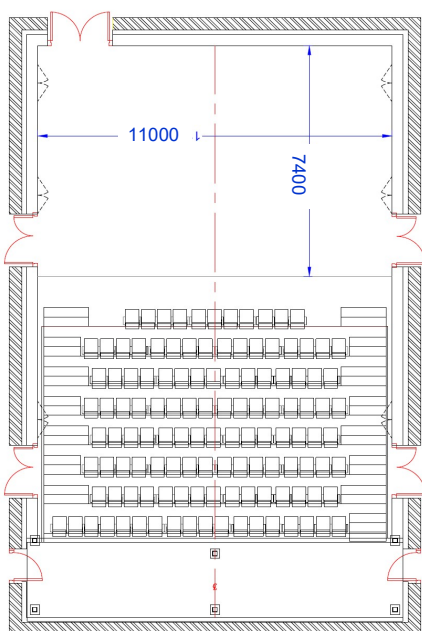

END STAGE (120 seats)

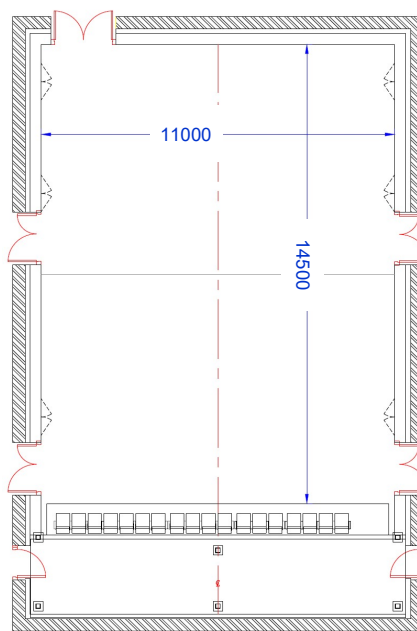

FLAT FLOOR (no seats)

STAGE HEIGHT

Clearance under structure 6.50m
Clearance under lighting truss 5.50m

STAGE FLOOR

Black hardboard floor 500kg/m² SWL

SIDE STAGE

Not available

REAR STAGE

Not available

STORAGE SPACE

Limited

CROSSOVER

Crossover via dressing rooms corridor



RIGGING

Truss A 10.00 x 8.45m (W x D)

Diameter 48mm
Loading Capacity 4000kg UDL

Truss B 10.00 x 4.40m (W x D)

Diameter 48mm
Loading Capacity 2000kg UDL

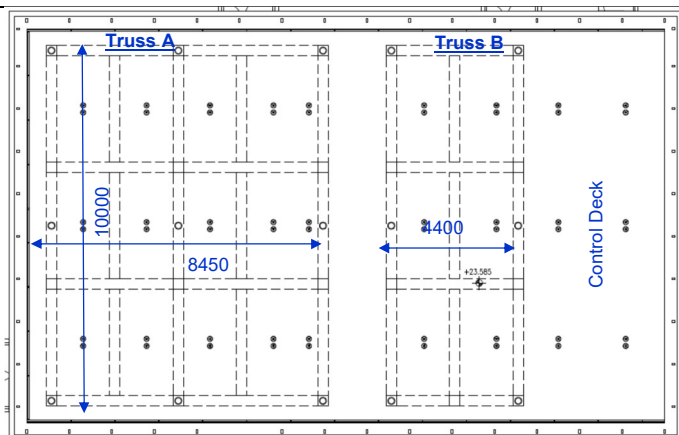

STAGE EQUIPMENT

Orchestra Riser 2.4 x 1.2m (W x L)

No drilling or painting on the platform
2 203mm (H)
2 407mm (H)
2 610mm (H)
2-step Stairway 2

Choir Riser 3 steps 3 sets
4 steps 3 sets with Back Rail

Conductor's Chair 1

Conductor's Podium 1 set

Conductor's Stand 1

Chair Musician Chair 50
High Stool 5
Cellist Stool 5

Musical Instrument Upright Piano 1 Yamaha YUS5

Music Stand Black 50

Table 6

Lift and Ladder Lifting Platform 2 *Operated by competent persons & prior approved by venue management only*

DRESSING ROOM

2/F (Stage Level) B1 10 persons
B2 10 persons

All dressing rooms fitted with private toilet and shower. Quick change facilities can be temporarily arranged when required.

RUNNING WARDROBE

Washing machines, dryers, located at 3/F and shared use with The Lab and The Turns.

Sewing machines, iron & boards and steamers can be loaned from Resident Stage Management Section.





LIGHTING

Power Circuit	ETC Digital Dimmer, 3kW	14
(in True1 Socket)	ETC Sensor3 Digital ThruPower Dimmer, 3kW	32
	ETC Sensor3 Relay Power Control Modules	30
Additional Power	63A 3-phase Socket	2

**Connection must be conducted by a local registered electrical worker.
Hirer shall supply adequate circuit protective devices for all bring-in electrical installations.**

Control Board grandMA3 Compact, located in Lighting Control Room.

House Light DMX controlled, controlled in Lighting Control Room.

Profile	167W	ETC	Source 4 Lustr 2 15/30°	16
Fresnel	167W	ETC	Source 4 Lustr 2 Fresnel	16
LED Automated Lighting	400W	HES	SolaPix 7	10
	480W	ETC	SolaFrame 1000	16
	480W	ETC	SolaWash 1000	10
PAR	180W	Silver Star	SS352XCEM	18
Fog Machine	1300W	Look Solutions	Viper NT	2
Hazer	1500W	Look Solutions	Unique 2.1	2
Music Light				30

Hirer will be provided with basic lighting only, unless sufficient preparation time is provided during the booking period and based on the complexity of the intended operation.

Supply of above equipment subject to availability on receipt of a lighting plan, minimum 3 weeks prior to booking commencement. Equipment availability does vary slightly according to equipment conditions and maintenance. Check with Resident Technical Manager for equipment updates.

All bring-in “Electrical and Stage Lighting Equipment” to be used in LCSD performance venues, shall meet the requirements of “Code of Practice for Electricity (Wiring) Regulations (2020 Edition)”. Please contact the venue management for any electrical safety concerns. Website reference:

http://www.emsd.gov.hk/emsd/eng/welcome/em_safety.shtml

SOUND

Sound System	Main System	
	L-Acoustics SB18i	2 (Fix-installed)
	Surround System	
	L-Acoustics 5XT	11 (Fix-installed)
Main Control Console	DiGiCo SD12	
	Mono Inputs	32
	Stereo Inputs	16
	Aux / Subgroup Outputs	12
Second Console	DiGiCo SD12	1



Microphone tie line	Each side of the stage	10
Stage Monitor	L-Acoustics X12	8
Microphone	Dynamic Vocal Mic	
	Shure Beta 58A	6
	Sennheiser e835S	2
	DPA 4018V-B-B01 d:facto	6
	Shure Nexadyne NXN8/S	4
	Dynamic Instrument mic	
	Shure Beta 57A	10
	AKG D112 MKII	1
	AKG SE 300B	2
	Condenser Mic	
	MKH 8040	2
	MKH 8050	2
	MKH 8070	2
	Neuman KM184	6
	Neuman KM185	6
	Shure Beta 52A	1
	AKG C414 XLS	2
	DPA 4055	2
	Shure Beta 87A	2
	Miniature Instrument Mic	
	DPA 4099 Core Class Kit X1	1 set
Wireless Microphone	Sennheiser Digital 6000 Wireless Mic System	
	Including: Handheld – SKM 6000	8
	Body Pack – SK6212	8
D.I.	BSS AR133	2
	RNDI	4
	RNDI-S	2
	Radial USB-Pro	2
	Radial SB-5	2
CD/SD/USB Playback	Denon DN-500BD MKII	2
	Tascam CD500B	2
	Tascam CDR-250N	2
Induction Loop	At auditorium	
Simultaneous Translation System	3-language infra-red wireless simultaneous translation system (incur extra charge)	
<u>COMMUNICATION</u>		
SM Desk	At control panel (max. four channels intercom system)	
Intercom System	Auditorium, stage and backstage	
	4-channel Main Station	1 set
	Wired Intercom	8 sets
	Wireless Intercom	6 sets
Cue Light System	Portable	8 sets



Paging and Show Relay System Dressing room and backstage area

PROJECTION

Multimedia Projector	Panasonic PT-RQ35K (at Designated Positions)	2
-----------------------------	--	---

SERVER

Media Server

VIDEO STREAMING & RECORDING

Streaming

PTZ Camera	Panasonic AW-UE160 (at Designated Positions)	5
Remote Control Panel	Panasonic AW-RP150	2
Camera Stand	Panasonic Polecam PanaPod	1
Video Switcher	Sony XVS-G1 with 1M/E 16 Button Control Panel	1
Streaming Encoder	Matrox Monarch Edge	1
Video Recorder	BMD HyperDeck Studio 4K Pro	7

TRACKING

Blacktrax
Zactrack Pro

Prior to the booking date, please confirm with Technical Manager the availability of the equipment. All required equipment will be set-up during the booking period; please allow adequate time in the production schedule for equipment set-up, tuning, alignment and test before rehearsal or performance.



POOLED LIGHTING EQUIPMENT LIST (Shared by all venues)

Profile	167W	ETC	Source 4 Lustr 2 Profile 15/30°	50
Fresnel	250W	Silver Star	SS826XH	16
LED Automated	480W	HES	SolaFrame 1000	30
Lighting	480W	HES	SolaWash 1000	10

POOLED SOUND EQUIPMENT LIST (Shared by all venues)

Microphone	Dynamic Vocal Mic		
	Shure SM58		4
	Shure Beta 58A		8
	Sennheiser e835S		2
	Beyerdynamic M88TG		1
	DPA 4018V-B-B01 d:facto		4
	Shure Nexadyne NXN8/S		6
	Dynamic Instrument mic		
	Shure SM57		1
	Shure Beta 57A		8
	AKG D112 MKII		1
	AKG SE 300B		1
	Condenser Mic		
	Audio-Technica AT4041		6
	Sennheiser MKH 8040		6
	Sennheiser MKH 8050		4
	Sennheiser MKH 8070		2
	Neumann KM184		8
	Neumann KM185		8
	Shure Beta 52A		1
	AKG C414 XLS		8
	DPA 4055		4
	Neumann U87 Ai		1
	Shure Beta 87A		6
	Miniature Instrument Mic		
	DPA 4099 Core Rock Kit		1
	DPA 4099 Core Class Kit X1		1

POOLED PROJECTION EQUIPMENT LIST

Multimedia Projector & Lens	Panasonic PT-RQ35K
	Lens ET-D75LE8 – 7.3-13.8:1
	Lens ET-D75LE10 – 1.3-1.7:1
	Lens ET-D75LE20 – 1.67-2.4:1
	Lens ET-D75LE30 – 2.4-4.7:1
	Lens ET-D75LE40 – 4.6-7.1:1
	Lens ET-D3LEW60 – 0.9-1.1:1
	Lens ET-D3LEU100 – 0.37:1

Equipment on this list is allocated on a **first come first served** basis, on presentation of complete production planning and work flow schematics.
Pool equipment cannot be reserved for any pending designs.